

Foot and Ankle Surgical System Solutions

CE 0197
ISO 13485 FDA



KANGLI ORTHOPAEDICS
INSTRUMENT

Calcaneal Locking Plate Series



JY Combo Minimally Invasive Calcaneal Locking Plate (Left,Right) **23209**



JY Combo Minimally Invasive Calcaneal Locking Plate (Max)(Left,Right) **23232**



JY Combo Minimally Invasive Calcaneal Locking Plate (Mini)(Left,Right) **23212**



JY Posterior Tuberosity Minimally Invasive Calcaneal Locking Plate(Left,Right) **23208**



JY Posterior Tuberosity Minimally Invasive Calcaneal Locking Plate (Mini)(Left,Right) **23211**



JY Anterior Process Minimally Invasive Calcaneal Locking Plate(Left,Right) **23210**



JY Anterior Process Minimally Invasive Calcaneal Locking Plate (Mini)(Left,Right) **23213**



WX Combo Minimally Invasive Calcaneal Locking Plate (Mini)(Left,Right) **23227**



JY Calcaneus Anatomical Locking Plate(Mini) (Left,Right) **23228**



JY Calcaneus Anatomical Locking Plate(Max) (Left,Right) **23230**

Tibial Fibula Locking Plate Series



JY Distal Anterolateral Tibial Locking Plate (Left,Right) **23204**



JY Distal Medial Tibial Locking Plate(Left,Right) **23203**



JY 2.7Distal Fibula Reconstruction Locking Plate (Left,Right) **23201**



JY Distal Tibial Medial Malleolus Locking Plate **23231**



JY Distal Tibial Posterior Malleolus Locking Plate **23234**

WX 2.5KML Micro Locking Plate Series



WX 2.5 KML Straight Micro Locking Plate **T41260**



WX 2.5 KML T-Type Micro Locking Plate(Two Holes In The Head) **T41261**



WX 2.5 KML L-Type Micro Locking Plate(Left, Right) **T41263**



WX 2.5 KML T-Type Micro Locking Plate(Three Holes In The Head) **T41262**

WX Calcaneal Locking Plate Series



WX Calcaneus Anatomical Locking Plate(Mini) (Left,Right) **23564**



WX Calcaneus Anatomical Locking Plate(Mid) (Left,Right) **23565**



WX Calcaneus Anatomical Locking Plate(Max) (Left,Right) **23566**



WX Combo Minimally Invasive Calcaneal Locking Plate (Max)(Left,Right) **23559**



WX Combo Minimally Invasive Calcaneal Locking Plate (Mini)(Left,Right) **23560**

WX Tibial Fibula Locking Plate Series



WX Distal Anteromedial Tibial Locking Plate(Left,Right) **23567**



WX Distal Medial Tibial Locking Plate(Left,Right) **23568**



WX Distal Anterolateral Tibial Locking Plate(Left, Right) **23561**



WX Distal Lateral Fibula Locking Plate-II (Left, Right) **23563**



WX Distal Fibula Reconstruction Locking Plate (Left,Right) **T4415**

Sterile Kirschner Wire Series

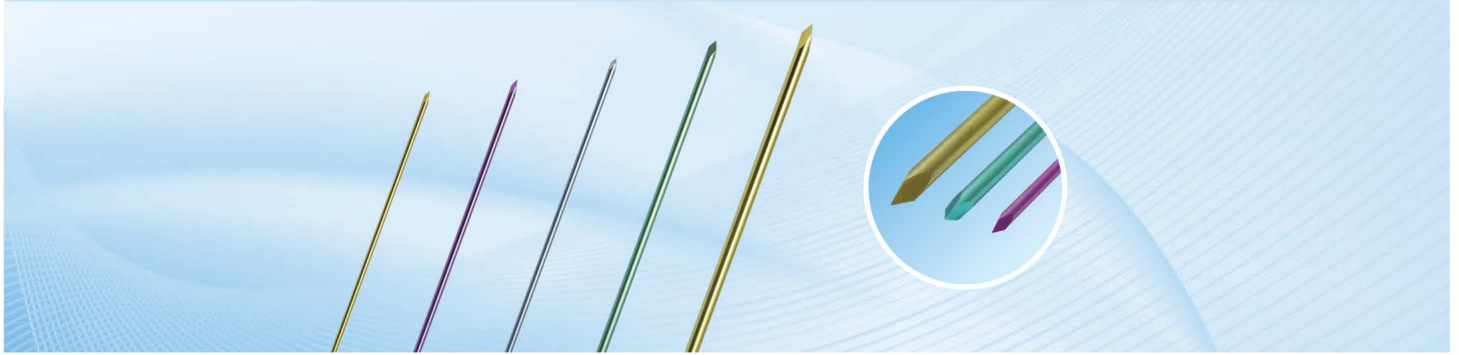

Mini Screw & Cannulated Screw Series

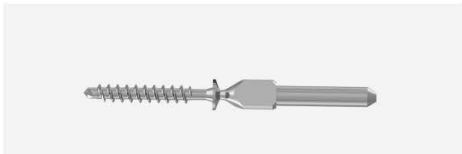

Φ2.0 Self-tapping & Drilling Screw **T50120**



Φ2.5 Self-tapping & Drilling Screw **T50125**

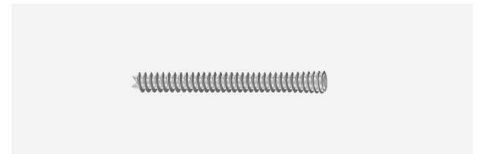

Φ2.5 Headless Cannulated Compression Screw **T57025**

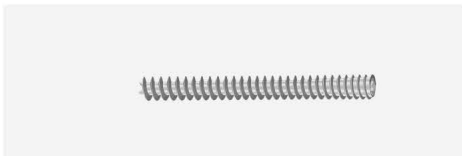

Φ3.5 Headless Cannulated Compression Screw **T57035**

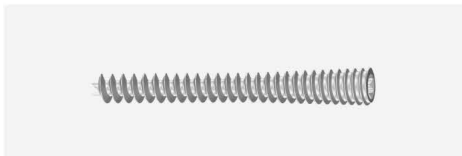

Φ4.5 Headless Cannulated Compression Screw **T57045**

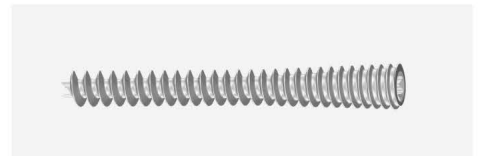

Φ6.5 Headless Cannulated Compression Screw **33504**



Φ2.5 Counter Sink Cannulated Compression Screw **33501**



Φ3.0 Counter Sink Cannulated Compression Screw **T5503**



Φ4.0 Counter Sink Cannulated Compression Screw **T5504**



Φ3.5 Cannulated Compression Screw **T551**



Φ4.0 Cannulated Compression Screw **T552**



Φ4.5 Cannulated Compression Screw **T553**

WX 2.7 Forefoot/Midfoot Variable Angel Locking Plate System

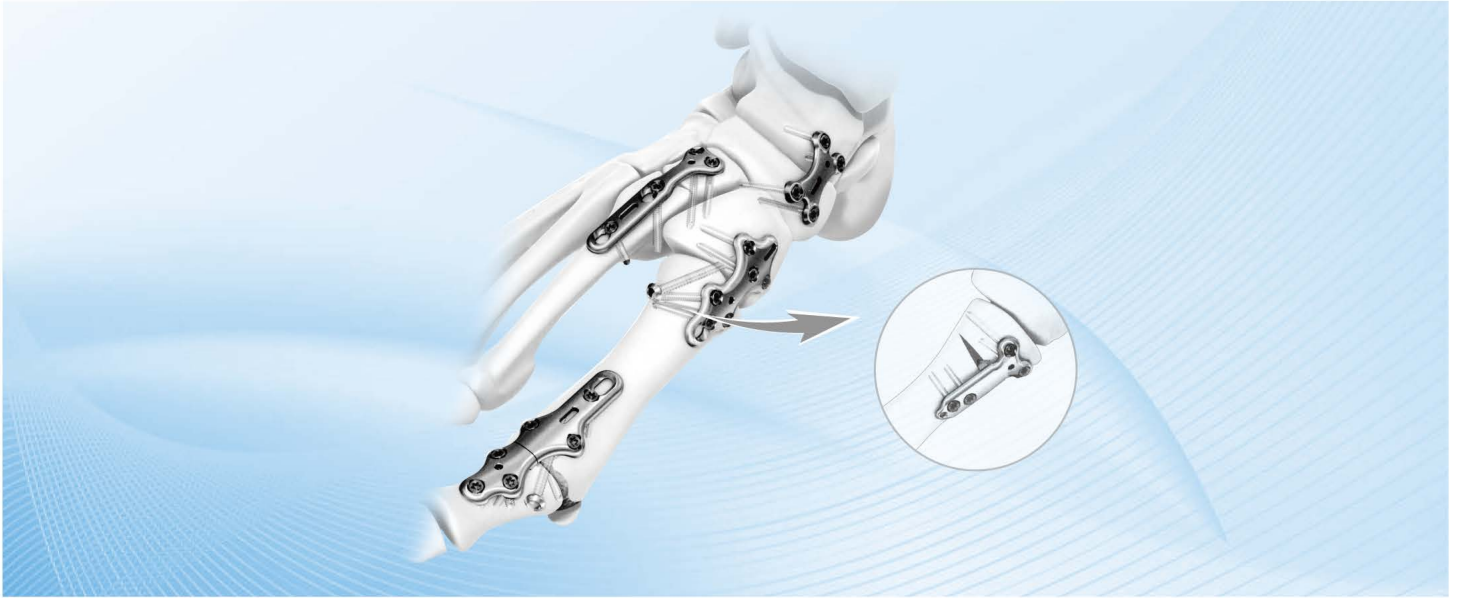

WX First TMT(Tarsometatarsal) Locking Fusion Plate **T47981**



WX TMT(Tarsometatarsal) Locking Fusion Plate **T47982**



WX Opening Wedge Variable Angle Locking Plate **T47983**



WX First MTP(Metatarsophalangeal) Locking Fusion Plate(Left,Right) **T47984**



WX X Type Universal Locking Fusion Plate **T47985**